

Framing channels system 28

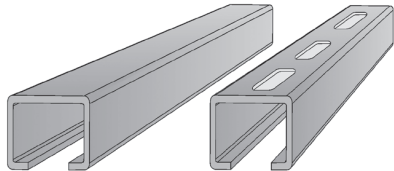

Framing channels cold rolled, suitable for welding and plugging.
 Material / finish: Steel mill finish (wb) and Steel hot dip galvanized (hdg),
 Stainless steel A4 and A2
 Matching T-bolts: HS 28/15, M6 - M12
 Matching locking plates GP 28/15 M4 - M10
 Delivery length ca. 6 m. Other length on request.

Framing channels plain back		Material / finish	Stock no.	Price € / m
	28/12	Steel wb	100.017	2,80
		Steel hdg	102.017	4,65
	28/15	Steel wb	100.016	3,30
		Steel hdg	102.016	5,50
		Steel sZn	104.016	4,45
		stainless steel A4	106.016	25,80
		stainless steel A2	108.016	20,40
	28/28	Steel wb	100.015	4,10
		Steel hdg	102.015	7,15
		Steel sZn	104.015	5,20
		stainless steel A4	106.015	29,55
		stainless steel A2	108.015	24,15

Framing channels slotted back		Material / finish	Stock no.	Price € / m
	28/15 Hole size 9 x 25	Steel wb	101.016	4,00
		Steel hdg	103.016	6,20
		Steel sZn	105.016	5,30
		stainless steel A4	107.016	27,65
		stainless steel A2	109.016	22,15
	28/28 Hole size 12 x 25	Steel wb	101.015	4,65
		Steel hdg	103.015	7,80
		Steel sZn	105.015	5,80
		stainless steel A4	107.015	32,90
		stainless steel A2	109.015	26,85

Fitting systems	Stock no.	Price € / St.	Fitting systems	Stock no.	Price € / pc.
28 flat	Steel zinc electroplating	Steel zinc electroplating	28 of Type 36/36	Steel hdg	Steel hdg
	640.185	4,90		640.980	3,45