

**Framing channels, slotted back - cold rolled**

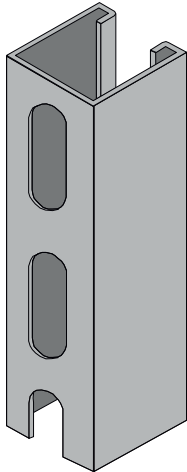

**26/18**

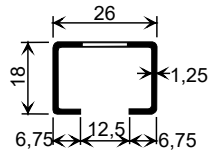

Finish: sZn

**28/15**

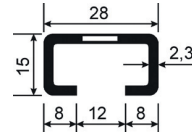

wb, hdg, A2, A4

**28/28**

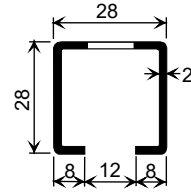

wb, hdg, sZn, A2, A4

**36/36**

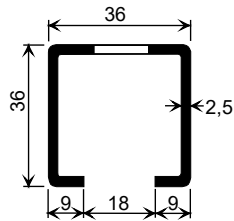

Finish: wb, hdg, sZn, A4

**41/22**

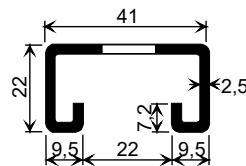

wb, hdg, A2, A4

**41/41**

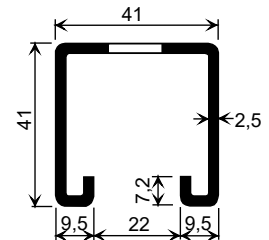

wb, hdg, A4

**41/62**

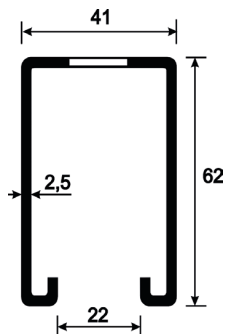

Finish: wb, hdg, sZn

**41/83**

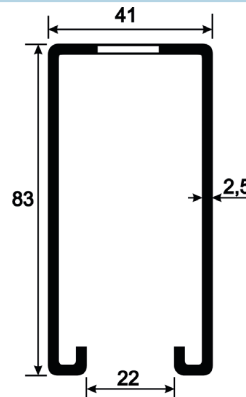

wb, hdg, sZn

**50/40**

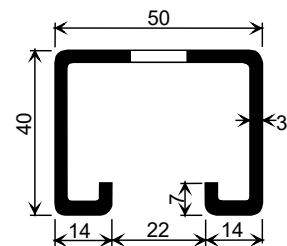

wb, hdg, A4

**Material /finish:**

wb = Steel St 37-2, mill finish

hdg = Steel St 37-2, hot dip galvanized

sZn = Steel St 02 Z 275, pre-galvanized

A2 = Stainless steel 1.4301

A4 = Stainless steel 1.4571/1.4401

Delivery length: Stock length ca. 6 m

Other dimension and material / finish on request.

Framing channels, slotted back - cold rolled

Technical data																	
Channels		Matching T-head-bolts		Channel data							max. perm. Point loading						
Type	Chan. weight kg/m	Type	Ø	A (cm <sup>2</sup> )	J <sub>y</sub> (cm <sup>4</sup> )	J <sub>z</sub> (cm <sup>4</sup> )	W <sub>y</sub> (cm <sup>3</sup> )	W <sub>z</sub> (cm <sup>3</sup> )	kN	cm		0,5	1,0	1,5	0,5	1,0	1,5
											F (kN) ①			Q (kN) ①			
26/18	0,63	28/15	M 6-12	0,73	0,30	0,92	0,34	0,70	0,7	28,0	0,38	0,19	0,12	0,76	0,38	0,24	
26/26	0,75	28/15	M 6-12	0,94	0,78	1,13	0,57	0,87	0,7	35,0	0,65	0,32	0,21	1,30	0,65	0,42	
28/15	0,98	28/15	M 6-12	1,25	0,34	1,43	0,43	1,02	3,3	7,0	0,50	0,24	0,10	1,00	0,38	0,17	
28/28	1,26	28/15	M 6-12	1,58	1,50	2,03	1,05	1,50	2,0	27,0	1,10	0,55	0,37	2,21	1,10	0,73	
36/36	2,00	38/17	M 10-16	2,52	3,94	5,92	2,09	3,31	3,5	34,0	2,34	1,12	0,78	4,68	2,34	1,56	
41/22	1,88	41/22	M 12-16	2,13	1,27	5,65	1,10	2,75	5,5	10,5	1,23	0,62	0,41	2,46	1,24	0,82	
41/41	2,54	41/22	M 12-16	3,04	6,11	9,16	2,83	4,47	5,5	27,0	4,10	2,02	1,34	8,35	4,08	1,48	
50/40	3,20	50/30	M 10-20	4,07	8,00	15,94	4,00	6,50	5,5	37,0	4,50	2,25	1,50	9,00	4,50	3,00	
											L=	1m	2m	3m	1m	2m	3m
41/62	3,12	41/41, 41/22	M 8-16	3,95	17,15	12,95	5,40	6,25	5,5	80,0	4,3	2,0	0,9	3,5	1,7	0,5	
41/83	3,89	41/41, 41/22	M 8-16	3,90	36,85	16,85	8,79	8,17	5,5	130,0	7,4	3,7	2,1	7,3	3,7	1,1	

① All load-capacity details take into account a permitted steel tension of  $G \leq 140 \text{ N/mm}^2$ .

Hole size and spacing	Type	D (mm)	L (mm)	A (mm)	a (mm)	Type						
							L (m)			L (m)		
							f (mm)			f (mm)		
	26/18	11	25	40	15	26/18	0,2	0,6	1,4	0,2	0,8	1,7
	26/26	11	25	40	15	26/26	0,1	0,4	0,9	0,1	0,5	1,2
	28/15	9	25	40	15	28/15	1,8	7,2	10,8	2,3	7,1	11,4
	28/28	12	25	40	15	28/28	0,9	3,7	8,5	1,1	4,8	10,4
	36/36	15	40	60	20	36/36	0,7	2,7	6,6	0,9	3,6	8,2
	41/22	14	30	50	20	41/22	1,6	6,4	14,5	2,0	8,0	18,7
	41/41	14	30	50	20	41/41	0,8	3,3	6,9	1,0	4,2	9,4
	41/62	14	30	50	20	41/62	0,4	2,1	4,8	0,7	2,7	6,1
	41/83	14	30	50	20	41/82	0,3	1,3	2,9	0,5	1,6	3,6
	50/40	18	40	60	20	50/40	0,7	2,8	6,4	0,8	3,5	7,8

Other hole sizes and spacing's on request. At the stainless steel channels „f“ has to be increased with the factor 1.24.